

Typi

Folio Case + Wireless Keyboard for iPad®2

Quick Start Guide

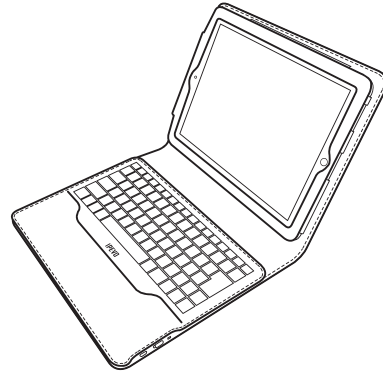

IPEVO
www.ipevo.com

Package Contents

Your package should contain the following:

- Folio Case made of premium felt and leather
- Wireless Bluetooth Keyboard
- MicroUSB-to-USB cord

Installing Your iPad 2

Installing your iPad 2 is simple.

1. Unclasp the outside strap and open the case.
2. Unfold the tab of the holder frame.
3. Insert your iPad into the holder frame. Ensure the device is inserted such that the iPad's rear camera lens lines up with Typi's lens cutout.
4. Refold the frame tab under the device.
5. Your iPad is now protected against dents, scratches, and wear and tear. Because the frame's design gives you full access to all of the iPad's buttons and ports, you won't have to take the iPad out.

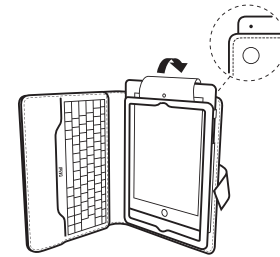

Pairing the Keyboard

Typi's keyboard operates via Bluetooth 2.0. It can communicate wirelessly with the iPad 2 in just a few steps.

1. Turn the keyboard on with the power switch ①: Red for no power, and green for power.
2. Press the pairing button ②. The pairing status LED will light up, letting you know the keyboard is ready to pair.
3. Go to "Settings" on your iPad. Under the "General" tab, hit "Bluetooth ③."
4. If Bluetooth is set to OFF, slide the setting to ON. The iPad will locate the keyboard.
5. Touch the keyboard device found to begin pairing.
6. A pop-up window on the iPad will instruct you to type in a four-digit code ④ on the Typi keyboard. Please type in the code from the iPad using the Typi keyboard and press Enter on the keyboard. The keyboard is now paired.

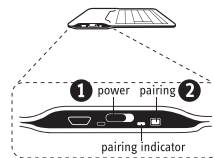

Using the Case as a Stand

Typi's built-in stand is perfect for positioning the iPad at a comfortable upright viewing angle. To do so, unbutton the outside strap. Then, angle the strap out and snap the top fastener into one of the three buttonholes. Choose the viewing angle that's right for you.

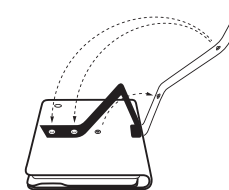

More on the back

Operating Options

Typi can be used with the iPad propped up with the built-in stand and the keyboard in its default position, much like a laptop.

However, you can easily detach the keyboard and use it at a distance for greater versatility – up to 33 feet (10 meters) away.

When you're done, just place the keyboard back onto Typi. Magnets will keep the keyboard in place.



Using the Keyboard

Typi's 83-key QWERTY-style keyboard comes with a top row of hotkeys to enhance your experience. Take a moment to familiarize yourself with these hotkeys:

- 1) **Home** – Return to the Home screen
- 2) **Search** – Bring up the search box to search for content on your iPad
- 3) **Copy** – Copy selected text
- 4) **Paste** – Paste text you have selected with Copy
- 5) **Gallery** – Begin a slideshow of the photos in your Photos app
- 6) **Keyboard** – Bring up the iPad's touchscreen keyboard
- 7) **Screenshot** – Capture a screenshot, which is stored in the Photos app
- 8) **Playback** – a) Rewind, b) Play/Pause, and c) Fast-forward for videos
- 9) **Mute** – Mute the sound
- 10) **Volume Up** – Increase the sound by one level
- 11) **Volume Down** – Decrease the sound by one level
- 12) **Lock** – Force iPad to go into sleep/lock mode
- 13) **Page up** – Scroll up quickly through text or web pages
- 14) **Page down** – Scroll down quickly through text or web pages
- 15) **Input Method** – Switch between keyboard layouts for international language support

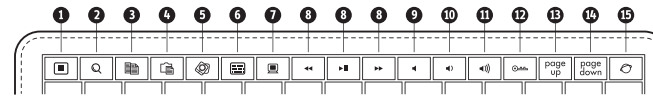

Charging the Keyboard

A fully-charged keyboard will operate for approximately 12 hours, with a standby time of 1 month. When it's time to recharge, use the included MicroUSB-to-USB cord to connect Typi's keyboard to any standard computer USB port. The keyboard will be fully charged in about 3 hours.

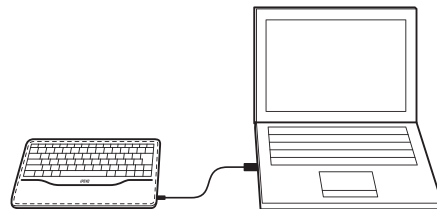

Care and Maintenance

Typi is made from a combination of real leather and premium felt. To keep Typi looking new, observe a few simple guidelines.

- 1) Don't leave Typi out in the sun for extended periods of time. Doing so may dry or crack the leather and make the felt lose its color.
- 2) Avoid rain or other types of moisture. If you do get Typi wet, absorb excess moisture with a soft cloth and then allow Typi to air-dry.
- 3) Don't use abrasive household cleaners with Typi. The felt portions of Typi can be hand-cleaned with a mild detergent if they get stained.

Any questions?

For any technical troubleshooting with this product, please navigate to Typi's support page at <http://support.ipevo.com/#Typi>

You may also send our Customer Support department an email at cs@ipevo.com

IPEVO
www.ipevo.com

Customer Service (USA)
Email: cs@ipevo.com
Tel: +1-408-490-3085

Customer Service (International)
Email: service@ipevo.com
Tel: +886-2-5550-8686